



RICHMOND

MicDrop



SLEEK, CHIC & DANGEROUS TO KNOW

MicDrop Richmond is quintessentially Richmond. Chic, hip, versatile and oh-so very innovative. With its polished concrete floor, exposed brick walls, and abundant natural light, it's a space that's designed to elevate your corporate event from 'meh' to mesmerising.

The 120sqm room includes a stage, dimmable lighting, breakout boardroom and high-speed wifi. There's even a connected kitchen to keep those celebratory end-of-event bevies nice and cold.

Ideal for workshops, team meetings, brainstorming and briefings, presentations and product launches.

Not suitable for bingo, weddings, bar mitzvahs, engagement parties or anything boring.

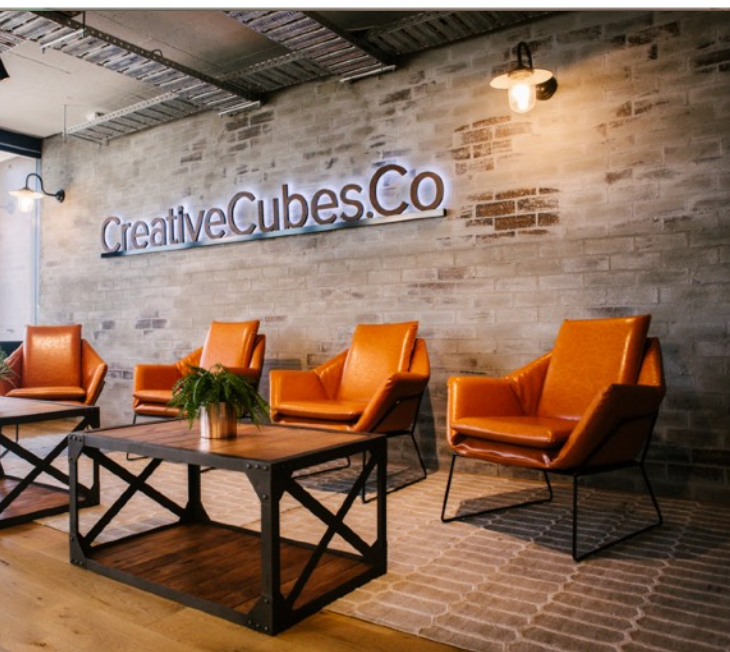

FLOOR PLAN



FLOOR PLAN OPTIONS

MAX CAPACITIES

Cocktail	80
Theatre	70
Banquet Rounds	48
Cabaret Rounds	40

THEATRE 50PAX
(VENUE DEFAULT)

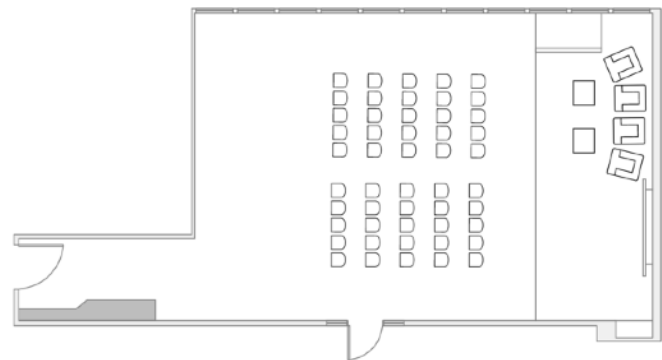

THEATRE 70PAX

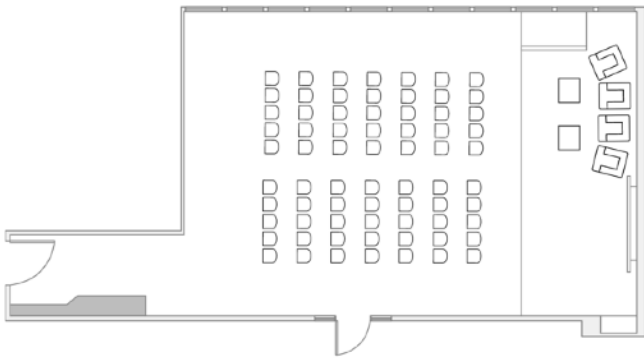

BANQUET 30PAX

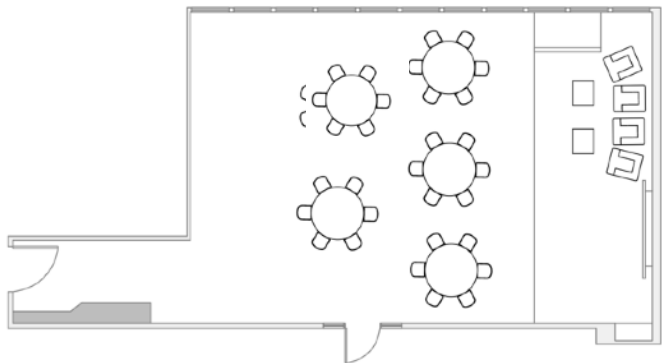

CABARET 25PAX

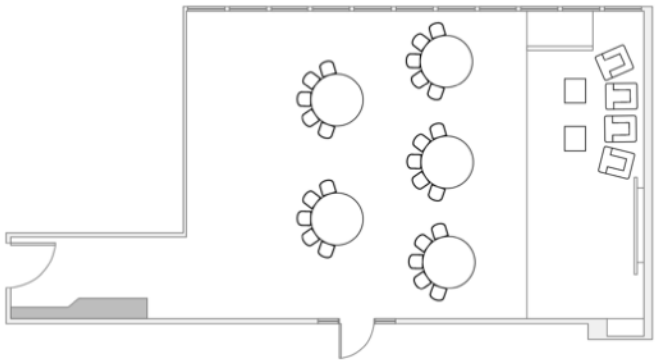

AUDIO VISUAL SYSTEM

We have designed a plug & plug AV system to make your experience a breeze. With side stage HDMI access for presenter use. Use of the AV system is \$300 p/day.

AUDIO

- 2 x handheld microphones
- 2 x lapel microphones
- 3.5mm or RCA audio input
- Apple AirPlay wireless control

VISION

- 96" multi-panel LCD screen
- HDMI input, aligned to audio
- Apple AirPlay wireless control

FURNITURE

Sleek custom designed lounge furniture is available for use, and included in venue hire. Should you require any additional furniture, you are welcome to arrange this via our recommended suppliers who know the venue well.

INVENTORY

- 12 x Trestle tables (1600mmW x 700mmD x 720mmH)
- 9 x Round banquet tables (1680mmD, 760mmH)
- 2 x Hightop cocktail tables (760mmD, 1100mmH)
- 1 x Hightop cocktail table (adjustable height, for laptop on stage)
- 70 x Wooden back leather chairs
- 4 x Brown single seater leather lounges
- 2 x Industrial coffee tables
- Venue also includes built in stage (3.4mD x 9mW)

RECOMMENDED SUPPLIERS

CATERING

MicDrop have an in-house catering team in each venue. If you are looking to bring in your own catering a \$400 buy out fee is applicable per day. Preparation space is made available to support offsite caterers, however no commercial kitchen space and no crockery/cutlery/glassware is available for use.

Only 10amp power is available on site, no 3phase or 15amp. In addition no food preparation that emits smoke is possible within the preparation space.

HIRE EQUIPMENT



03 9429-8688
harrythehirer.com.au

ADDITIONAL AV EQUIPMENT



David Wailes
dave@technicalevents.com.au
03 9372 6886
technicalevents.com.au

CATERING

BY GOODIE FOOD & EVENTS

To keep your team fuelled, Goodie is on hand to curate and serve healthy, wholesome and delicious food.

MORNING OR AFTERNOON TEA

\$16.00 per person

LUNCH

\$36.00 per person

HALF DAY

Morning Tea + Lunch, or Lunch + Afternoon Tea

\$50.00 per person

FULL DAY

Morning Tea + Lunch + Afternoon Tea

\$65.00 per person

BEVERAGES

All day sparkling & still water included

Softs, juice and alcoholic beverage packages also available

Package options below for continuous tea & coffee service:

2hr Duration \$5.00pp

Half day duration \$10.00pp

Full Day \$15.00pp

For any special dietary requests an additional fee of \$8.00 applies per person/per day

All prices include GST and staffing for your event

Minimum order 15 guests



NEED A MEETING ROOM?

A range of meeting rooms are available to hire on a per hour basis.

Plug & play technology

- Large TV screen connectable via HDMI
- Lighting fast WiFi
- White board & whiteboard markers

Catering

- Sparkling & still water on tap
- Catering be arranged with our friends at Goodie, who will keep the team fuelled by serving healthy, wholesome and delicious food

HOURLY PRICING & ACCESS TIMES

Meeting rooms can be booked between the hours of 8:30am - 5:00pm (unless booked in conjunction with the MicDrop Richmond event space).

- | | |
|----------------------------------------------|----------------------------------------|
| • Hustle Boardroom (20 pax)
\$75 per hour | • GOAT Room (6pax)
\$35 per hour |
| • Unicorn Room (8pax)
\$35 per hour | • Mani's Room (6 pax)
\$35 per hour |
| • Flamingo Room (8pax)
\$35 per hour | • Passion Room (6pax)
\$35 per hour |

Please note, pricing does not include GST.

TO BOOK

Should you wish to book a meeting room in conjunction with the MicDrop Richmond event space, please reach out to the MicDrop team! Otherwise, feel free to head to creativecubes.co/meetings





NEED TO KNOW VENUE INFO

CONTACT

1300 020 636

hello@micdrop.events

7 DAYS

MicDrop Richmond is available 7 days a week from 8:00am - 12:00am

RESTROOMS

Dedicated male & female restrooms as well as separate accessible restroom

HEATING & COOLING

Keep your guests comfortable with full in house heating & cooling

LOADING BAY ACCESS

Loading Bay at rear of venue with access from William St (see map)

ADDRESS

Level 4

534 Church St, Richmond

STREET PARKING

Along Church St, fees apply

TRAIN

East Richmond Station

PAID PARKING

Ace Parking

560 Church St, Richmond (rear)

TRAM

Route 78

Gibbons St/Church St Stop

Adelaide St/Church St Stop

Wilson Parking

658 Church St, Richmond

East Richmond Station

(council parking)



LOOKING FOR
A DIFFERENT VENUE?

INTRODUCING MICDROP HAWTHORN

This ain't your Aunt Edna's Hawthorn. MicDrop Hawthorn brings Gotham City swagger to Melbourne's leafy inner east. Exposed brick and industrial-chic accents provide the perfect backdrop for events that will linger longer in people's memories.

Along with all the cutting-edge event-tech you'd expect from a space this fly, the 145sqm room includes dimmable lighting and blazing fast wifi, as well as breakout boardroom and meeting rooms for when you just can't contain all your good ideas in one space.

And to keep your team fuelled, catering partner Timber + Greens is on hand to curate and serve healthy, wholesome, delicious food sourced from local and (where possible) certified organic producers. Their coffee is out of this world too.

Ideal for workshops, team meetings, brainstorming and briefings, presentations and product launches. Not suitable for sheep shearing, drumming circles or anything boring.



LOOKING FOR
A UNIQUE VENUE?

MICDROP SOUTH MELBOURNE

Here it is, the new kid on the block. So close to the South Melbourne market you can almost smell the dimmies. Yet in a league of it's own when it comes to style and panache.

A spacious 213sqm corner venue with city views, MicDrop South Melbourne has everything you'd expect from a creative venue space. Concrete floors, plenty of natural light, first-class AV tech and a vibe that's second to none.

Our catering partner Timber + Greens is also based here, so fresh delicious brain fuel and kick-arse caffeine fixes are a specialty.

Ideal for workshops, team meetings, brainstorm & briefings, presentations & product launches. Not suitable for CWA cake stalls, your cousin Robbie's 21st & anything boring.