

A red wavy line graphic that starts on the left, loops around the word 'HAWTHORN', and extends to the right.

HAWTHORN

MicDrop

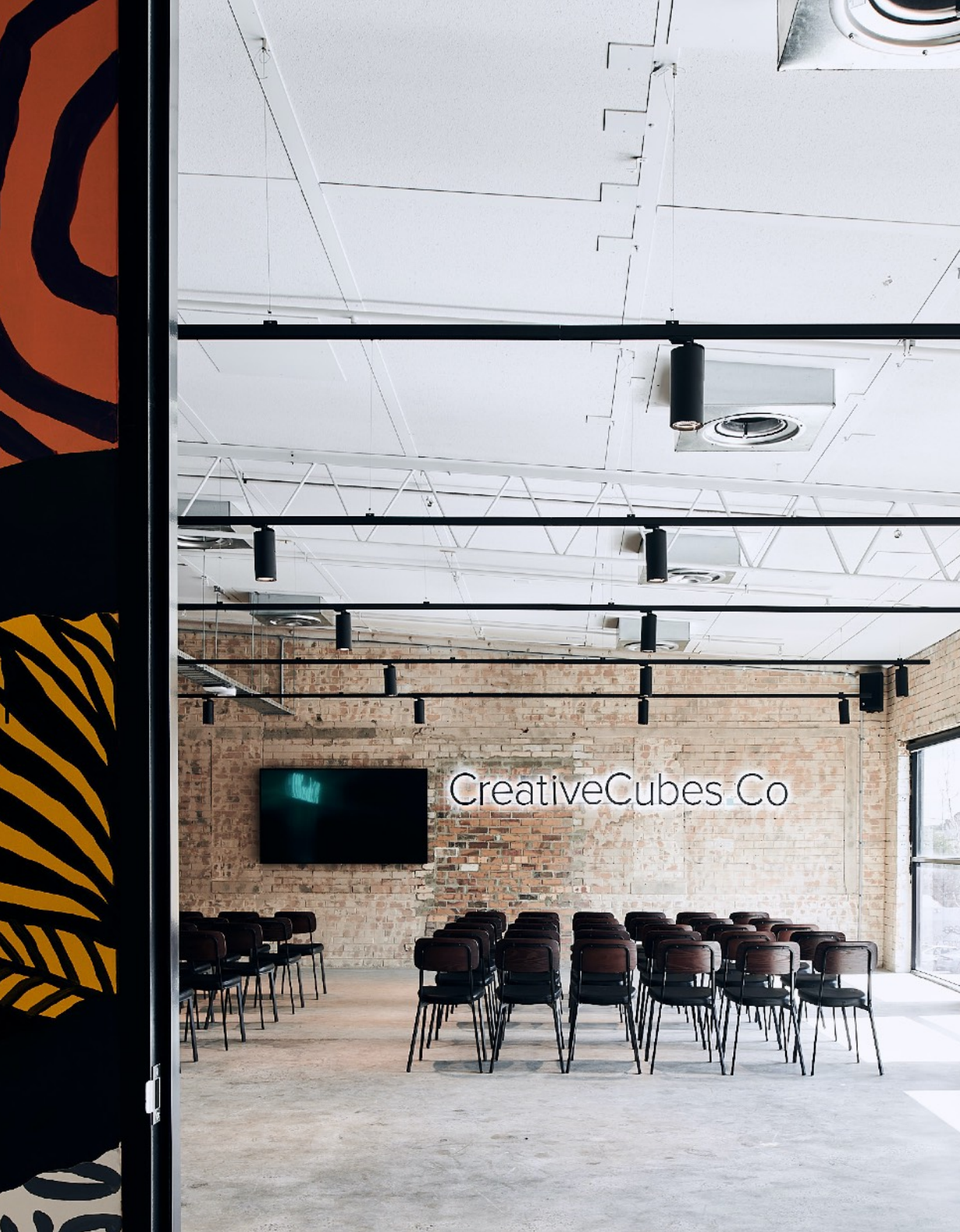

GOTHAM CITY SWAGGER. HAWTHORN COOL.

This ain't your Aunt Edna's Hawthorn. MicDrop Hawthorn brings Gotham City swagger to Melbourne's leafy inner east. Exposed brick and industrial-chic accents provide the perfect backdrop for events that will linger longer in people's memories.

Along with all the cutting-edge event-tech you'd expect from a space this fly, the 145sqm room includes dimmable lighting and blazing fast wifi, as well as breakout boardroom and meeting rooms for when you just can't contain all your good ideas in one space.

And to keep your team fuelled, catering partner Timber + Greens is on hand to curate and serve healthy, wholesome, delicious food sourced from local and (where possible) certified organic producers. Their coffee is out of this world too.

Ideal for workshops, team meetings, brainstorming and briefings, presentations and product launches. Not suitable for sheep shearing, drumming circles or anything boring.

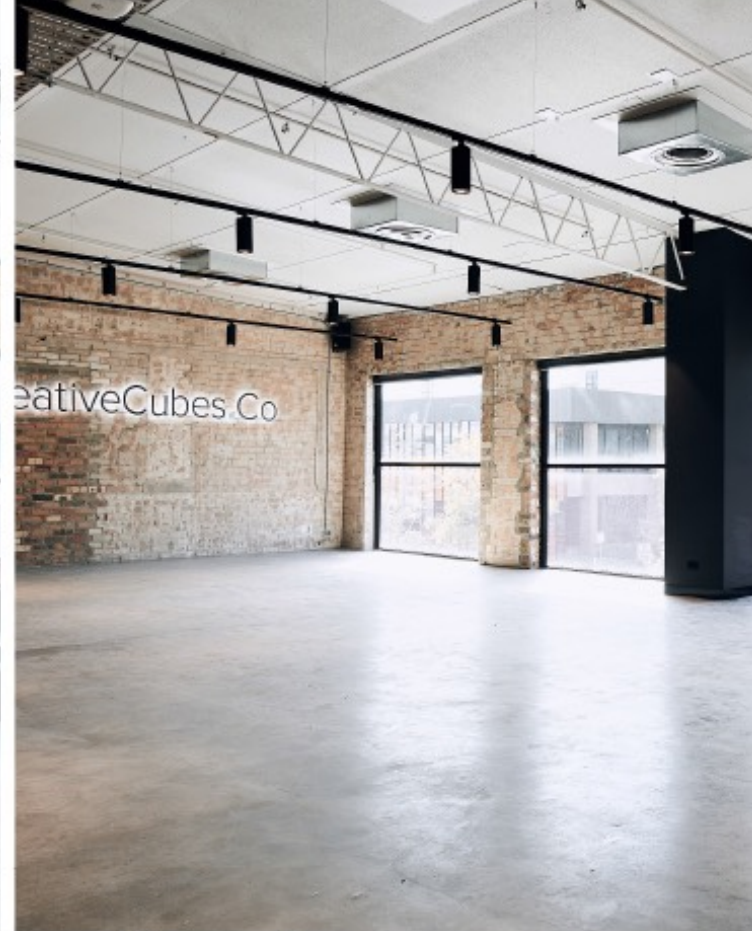

FLOOR PLAN



FLOOR PLAN OPTIONS

CAPACITY

Cocktail	150
Theatre	100
Banquet Rounds	48
Cabaret Rounds	40

THEATRE 60PAX
(VENUE DEFAULT)

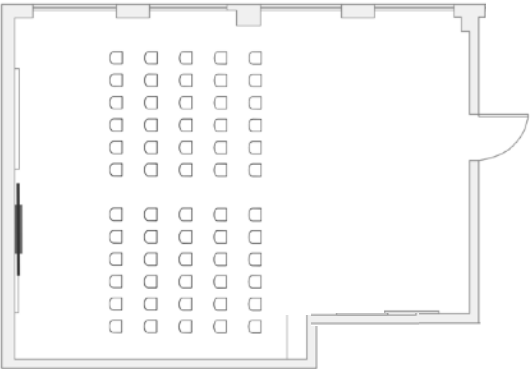

THEATRE 100PAX

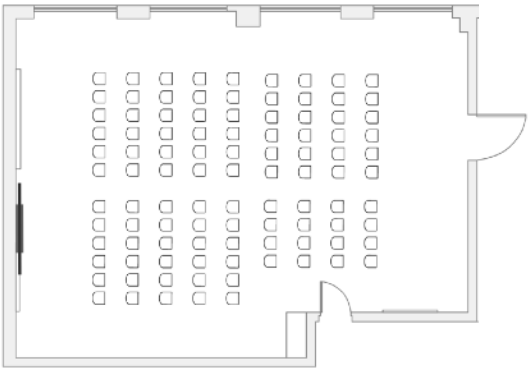

BANQUET 48PAX

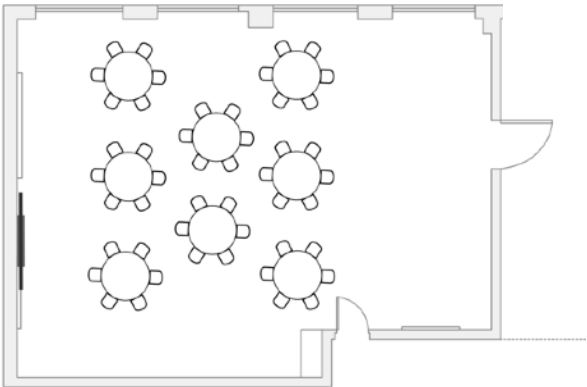

CABARET 40PAX

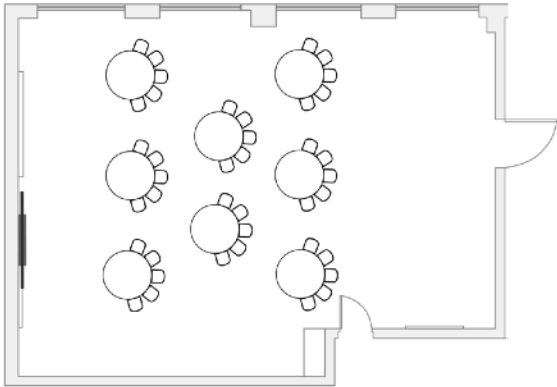

AUDIO VISUAL SYSTEM

We have designed a plug & plug AV system to make your experience a breeze. With side stage HDMI access for presenter use. Use of the AV system is \$300 p/day.

AUDIO

- 2 x handheld microphones
- 3.5mm or RCA audio input
- 2 x lapel microphones
- Apple AirPlay wireless playback
- PC/Android Miracast wireless playback

VISION

- 84" 4K screen
- HDMI input, aligned to audio
- Apple AirPlay wireless screen share
- PC/Android Miracast wireless screen share

FURNITURE

Sleek custom designed lounge furniture is available for use, and included in venue hire. Should you require any additional furniture, you are welcome to arrange this via our recommended suppliers who know the venue well.

INVENTORY

- 14 x Trestle tables (1600mmW x 700mmD x 720mmH)
- 9 x Round banquet tables (1680mmD, 760mmH)
- 3 x Catering stations on castors (1800mmL x 700mmD, 1100mmH)
- 3 x Hightop cocktail tables (760mmD, 1100mmH)
- 110 x Wooden back leather chairs

RECOMMENDED SUPPLIERS

CATERING

MicDrop have an in-house catering team in each venue. If you are looking to bring in your own catering a \$400 buy out fee is applicable per day. Preparation space is made available to support offsite caterers, however no commercial kitchen space and no crockery/cutlery/glassware is available for use.

Only 10amp power is available on site, no 3phase or 15amp. In addition no food preparation that emits smoke is possible within the preparation space.

HIRE EQUIPMENT



03 9429-8688
harrythehirer.com.au

ADDITIONAL AV EQUIPMENT



David Wailes
dave@technicalevents.com.au
03 9372 6886
technicalevents.com.au

CATERING

BY TIMBER + GREENS

To keep your team fuelled, our in house caterer is on hand to curate and serve healthy, wholesome, delicious food sourced from local and where possible certified organic producers. Their coffee is out of this world too.

Reach out to MicDrop for the seasonal menu.

MORNING OR AFTERNOON TEA

\$16.00 per person

LUNCH

\$36.00 per person

HALF DAY

Morning Tea + Lunch, or Lunch + Afternoon Tea
\$50.00 per person

FULL DAY

Morning Tea + Lunch + Afternoon Tea
\$65.00 per person

TEA & COFFEE

Selection of T2 favourites
+ Sirius Coffee

2hr Duration \$4.00pp
Half day duration \$6.00pp
Full Day \$8.00pp

All day sparkling & still water included
For any special dietary requests an additional fee of \$8.00 applies per person/per day
All prices include GST and staffing for your event
Minimum order 15 guests



NEED A MEETING ROOM?

A range of meeting rooms are available to hire on a per hour basis.

Plug & play technology

- Large TV screen connectable via HDMI (not included in Think Tank Rooms)
- Lighting fast WiFi
- White board & whiteboard markers

Catering

- Sparkling & still water on tap
- Catering can be arranged with our friends at Timber+Greens, who will keep the team fuelled by serving healthy, wholesome and delicious food

HOURLY PRICING & ACCESS TIMES

Meeting rooms can be booked between the hours of 8:30am - 5:00pm (unless booked in conjunction with the MicDrop Hawthorn event space).

- | | |
|---|---|
| • Courtside Boardroom (20 pax)
\$75 per hour | • Goal Digger Room (6pax)
\$35 per hour |
| • Showtime Room (8pax)
\$35 per hour | • Lulu Room (4 pax)
\$35 per hour |
| • Boom Room (6pax)
\$35 per hour | • Think Tank Rooms (4 pax)
\$35 per hour |

Please note, pricing does not include GST.

TO BOOK

Should you wish to book a meeting room in conjunction with the MicDrop Richmond event space, please reach out to the MicDrop team! Otherwise, feel free to head to creativecubes.co/meetings





NEED TO KNOW VENUE INFO

CONTACT

1300 020 636

hello@micdrop.events

7 DAYS

MicDrop Hawthorn is available 7 days a week from 8:00am - 12:00am

RESTROOMS

Dedicated male and female restrooms as well as separate accessible restroom

HEATING & COOLING

Keep your guests comfortable with full in house heating & cooling

ADDRESS

10 Oxley Road
Hawthorn
VIC 3122

STREET PARKING

Along Glenferrie Road & Oxley Road,
fees apply

PAID PARKING

Directly opposite MicDrop Hawthorn is
a paid parking facility, local council
managed.

TRAIN

Glenferrie Station

TRAM

Route 16
Manningtree Road Stop
Manningtree Road /
Glenferrie Rd Stop

M-F, 8am - 4pm (paid)
\$3p/hr or \$6.50 all day
Outside of these times it's free
(pricing subject to change)



INCORPORATE MINDFUL MOVEMENT WITH ...

REBELMONK

Rebel Monk shares the house with MicDrop in Hawthorn. The state-of-the-art studio is ideal for bringing balance to your next event.

Rebel Monk exists for every level of fitness and experience; to connect body, breath and mind so you can reset, replenish, and reach your potential.

With thirty mat spaces, spa-quality changing rooms and an incredible array of experienced teachers, why not bring Yoga or Meditation to your next event?

Either allow your guests the opportunity to join one of Rebel Monks regularly timetabled Yoga classes, or work with our team to incorporate a custom Yoga or Meditation session to your event. Whatever your Wellness requirements are, Rebel Monk are here to support.

Contact the MicDrop team for more information.

RM



**INCREASE YOUR
EVENT IMPACT**

EXCLUSIVE GROUP SESSION

**AT THE HOTTEST
NEW WORKOUT STUDIO
IN HAWTHORN**

GET TO THE HEART OF FITNESS



Our technology
connects your heart
to your workout.



Our heart rate zones
tell you when to push harder.
And when not to.



Our coach-led workouts are
specifically designed to get the
most out of your 60 minutes.



03 8579 1975
studiomanager013@orangetheoryfitness.com.au

*Visit [Orangetheoryfitness.com.au/terms-of-use](https://www.orangetheoryfitness.com.au/terms-of-use) for more details, terms and conditions.



LOOKING FOR
A DIFFERENT VENUE?

INTRODUCING MICDROP RICHMOND

MicDrop Richmond is quintessentially Richmond. Chic, hip, versatile and oh-so very innovative. With its polished concrete floor, exposed brick walls, and abundant natural light, it's a space that's designed to elevate your corporate event from 'meh' to mesmerising.

The 120sqm room includes a stage, dimmable lighting, breakout boardroom and high-speed wifi. There's even a connected kitchen to keep those celebratory end-of-event bevies nice and cold.

Ideal for workshops, team meetings, brainstorming and briefings, presentations and product launches. Not suitable for bingo, weddings, Bar Mitzvahs, engagement parties or anything boring.



LOOKING FOR
A UNIQUE VENUE?

MICDROP SOUTH MELBOURNE

Here it is, the new kid on the block. So close to the South Melbourne market you can almost smell the dimmies. Yet in a league of it's own when it comes to style and panache.

A spacious 213sqm corner venue with city views, MicDrop South Melbourne has everything you'd expect from a creative venue space. Concrete floors, plenty of natural light, first-class AV tech and a vibe that's second to none.

Our catering partner Timber + Greens is also based here, so fresh delicious brain fuel and kick-arse caffeine fixes are a specialty.

Ideal for workshops, team meetings, brainstorm & briefings, presentations & product launches. Not suitable for CWA cake stalls, your cousin Robbie's 21st & anything boring.